

PHONE mount

CONSTRUCTION MANUAL

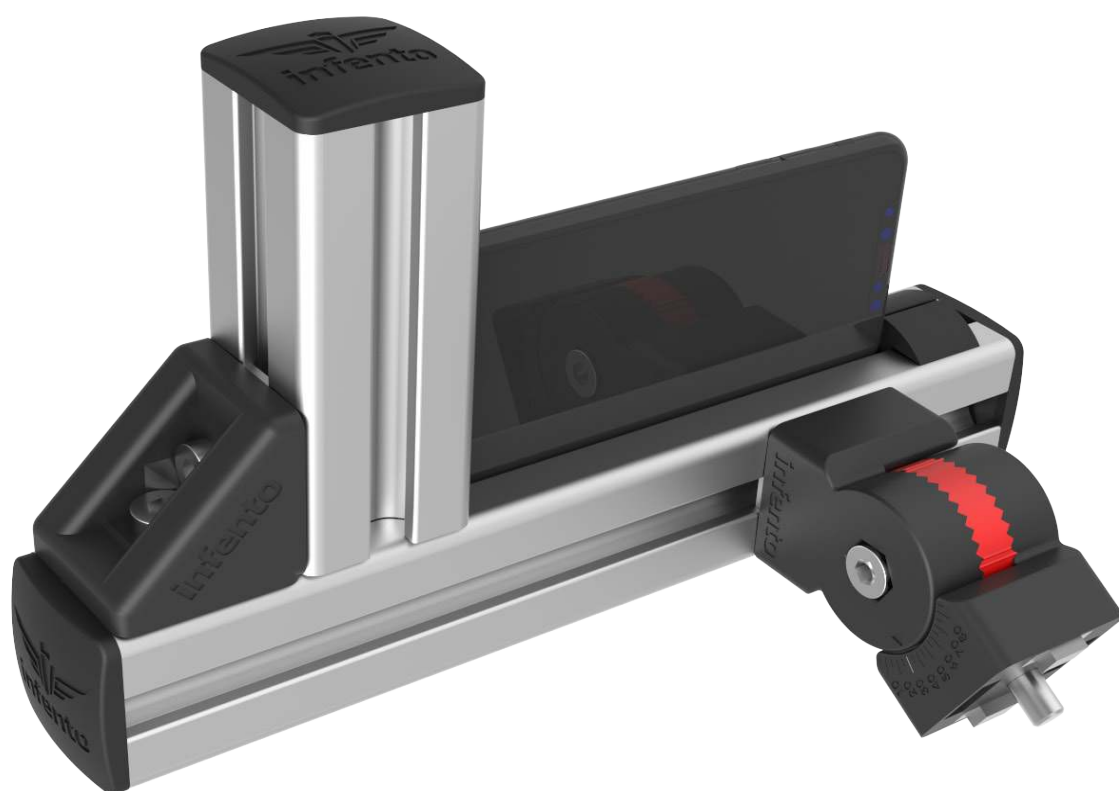

Time to build 15 min



1

Phone mount

First, get all required materials stated here and then follow the instructions.

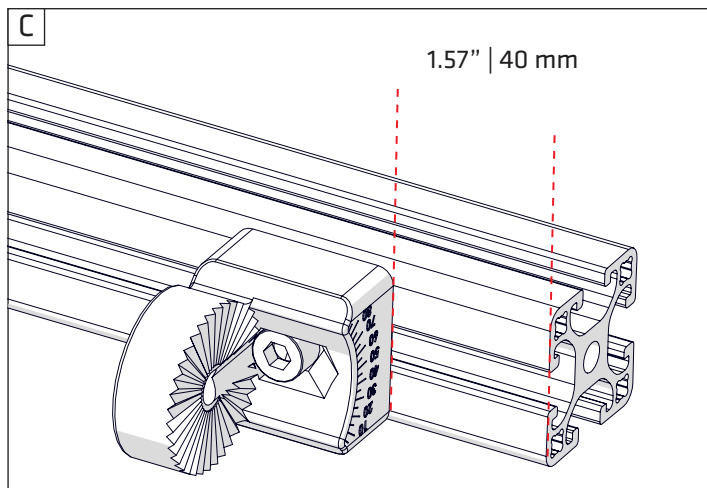
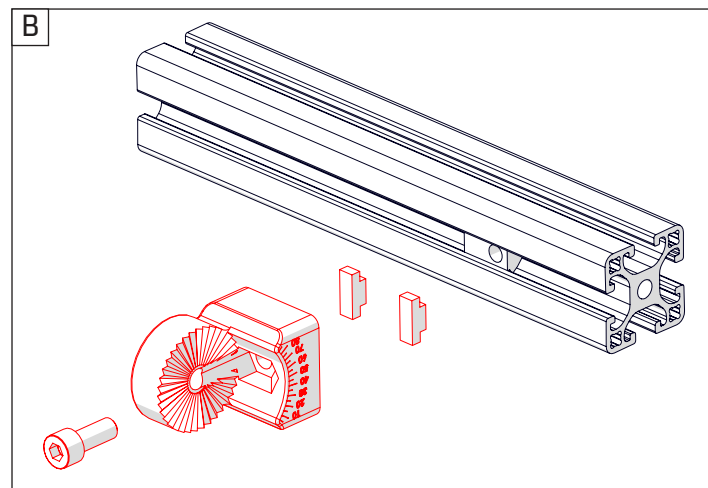
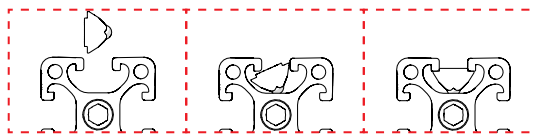
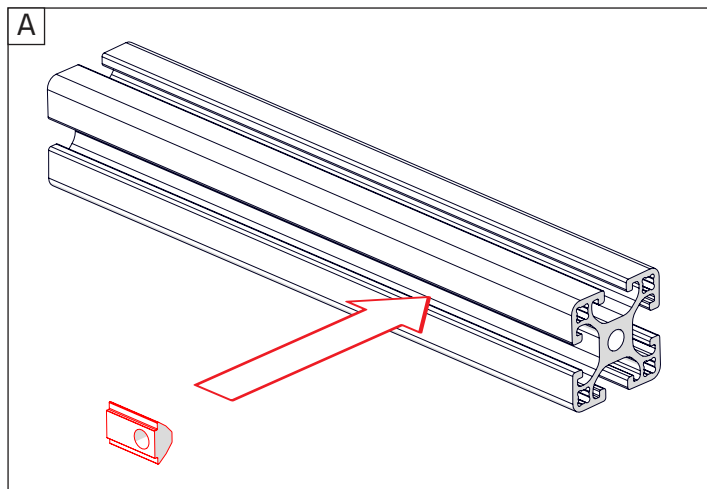
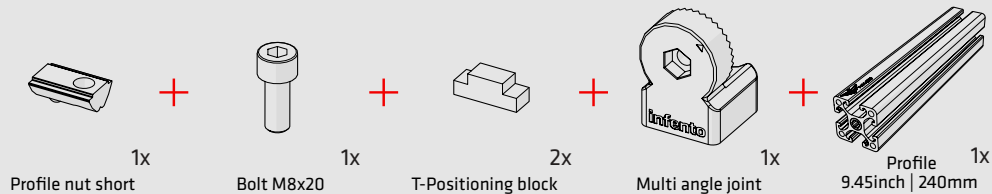

Tighten the bolts with full force. Ensure that you hold the long side of the Allen key in your hand as this enables you to exert greater force.

Double check here: Does your result looks **exactly** like the image at the bottom of the page?

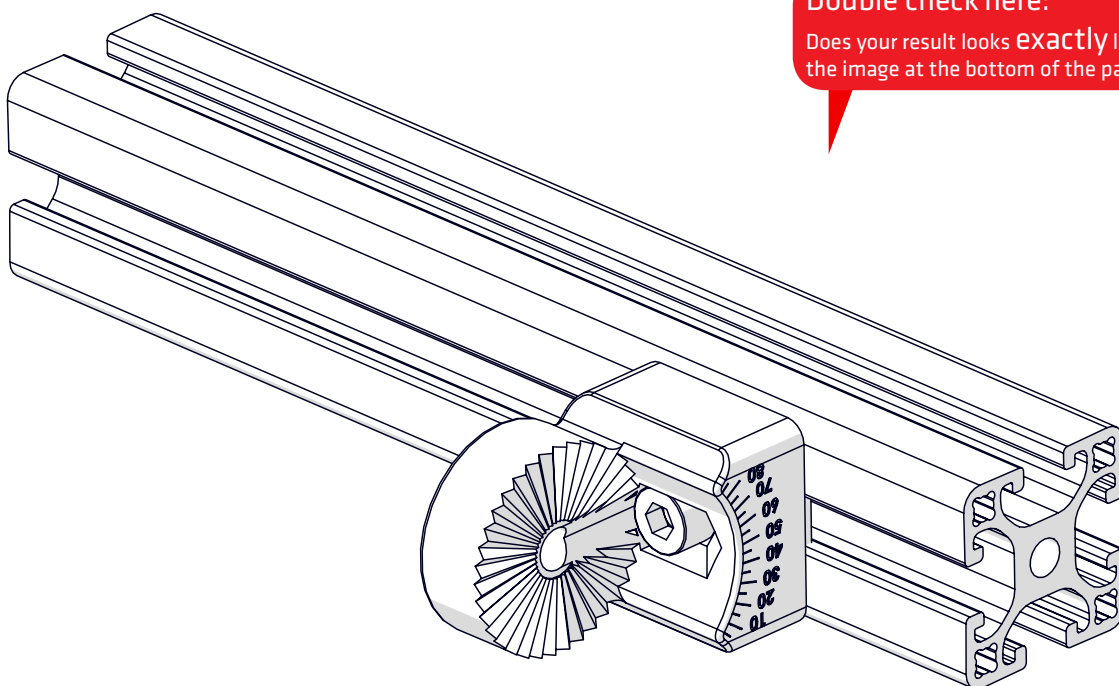

TOP 3 REQUIREMENTS MAKING A GREAT INFENTO EXPERIENCE:



1

Tighten bolts with full force (15Nm) to prevent them from coming loose.

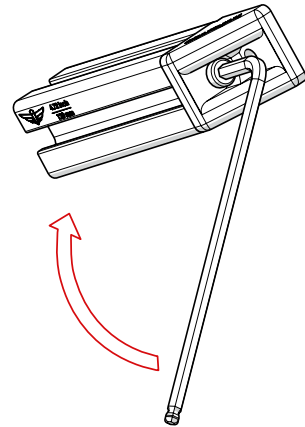

2

Constructing and playing always under supervision of an adult.



3

Check frequently if all parts are still firmly tightened and function properly.





2

Phone mount

- Profile nut short 1x
- L-joint 1x
- Bolt M8x20 (low head) 1x
- T-Positioning block 2x
- Profile 3.15inch | 80mm 1x

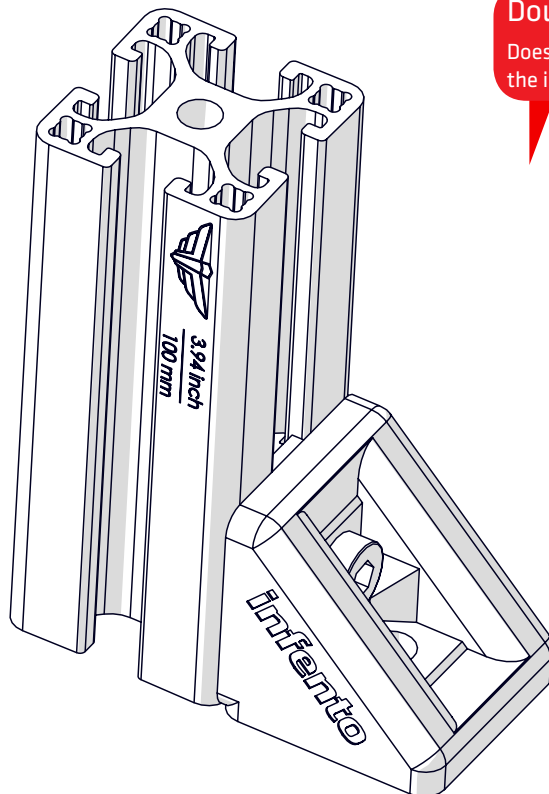
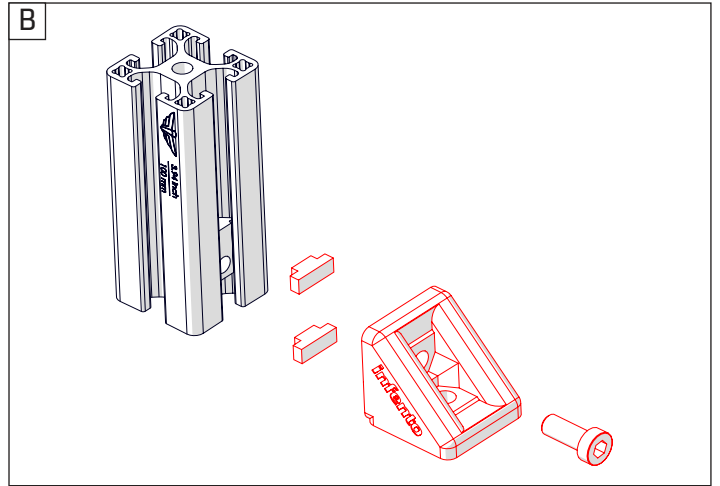
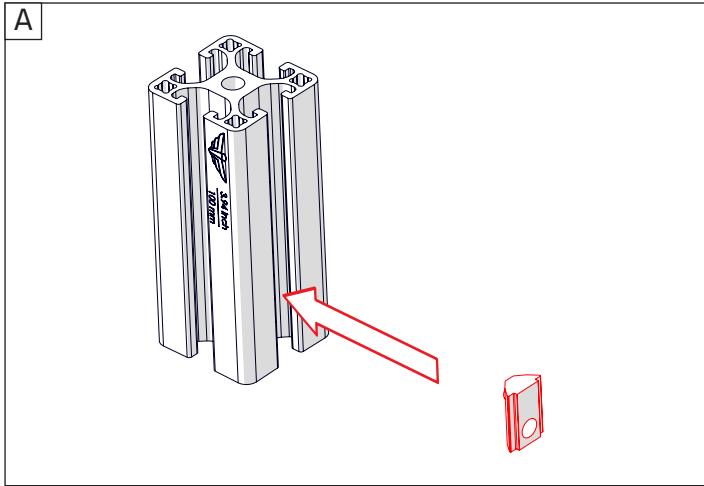

Double check here:
Does your result looks **exactly** like the image at the bottom of the page?



3

Phone mount



+



+



Bolt M8x20 1x
(low head)

T-Positioning block 1x

Profile nut short 1x

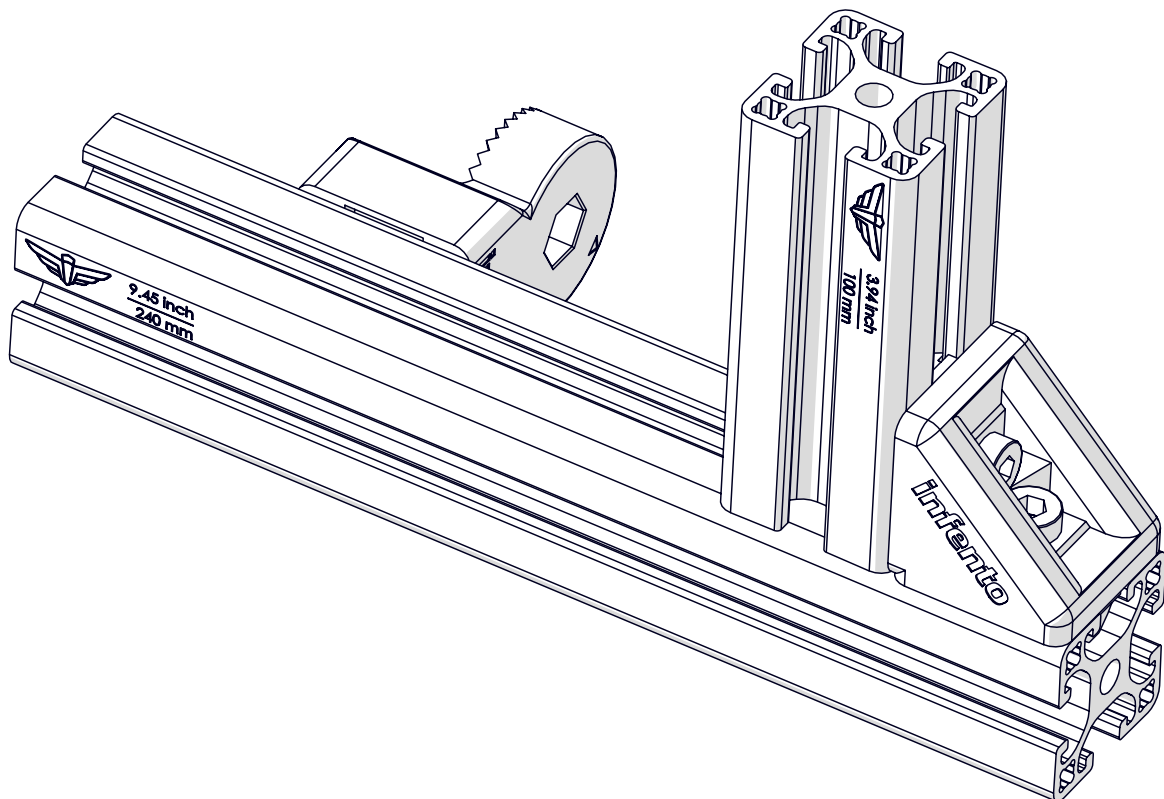
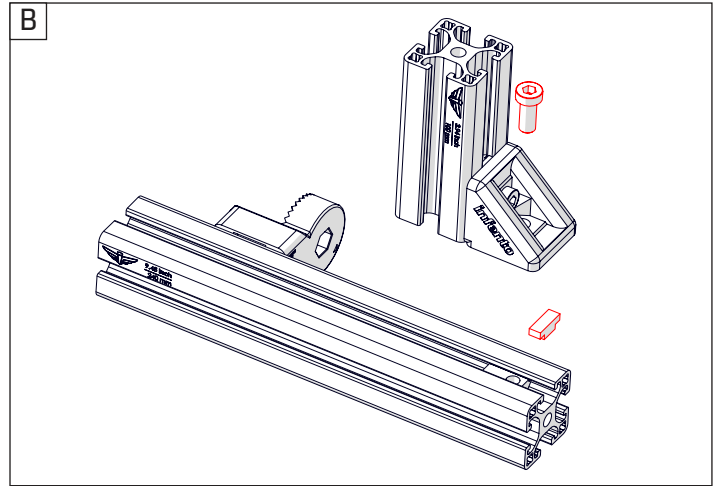
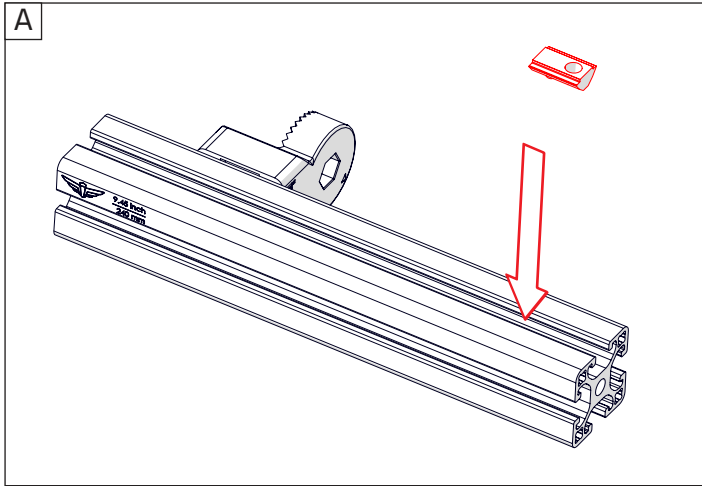



4

Phone mount



3x



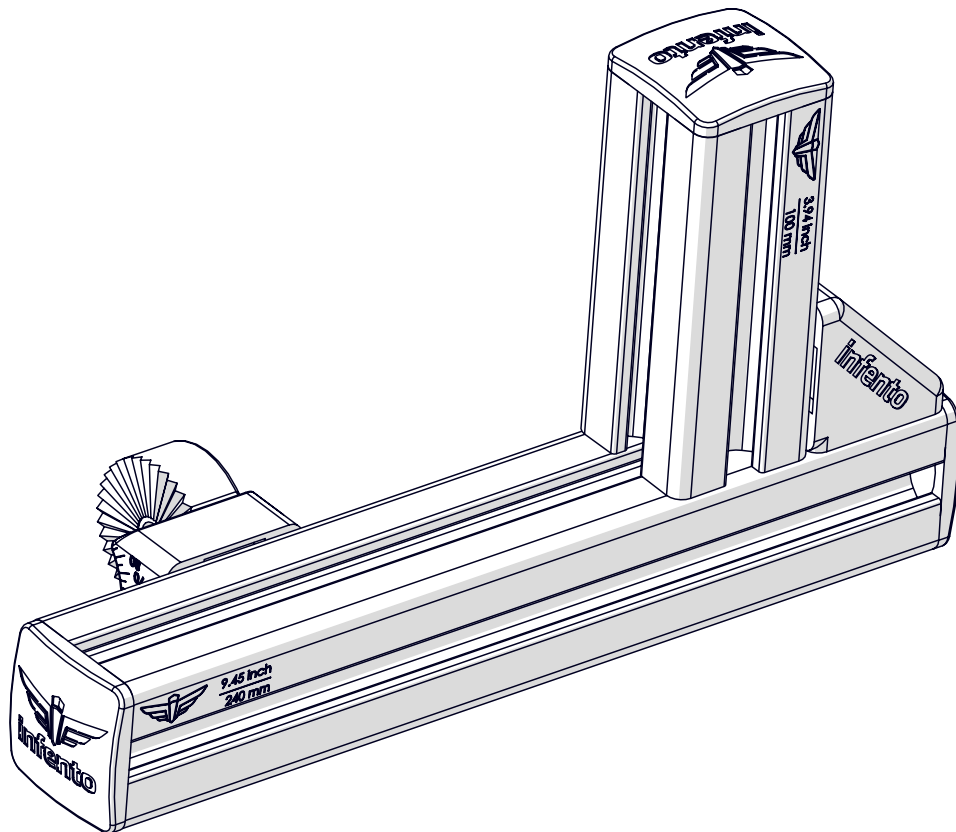
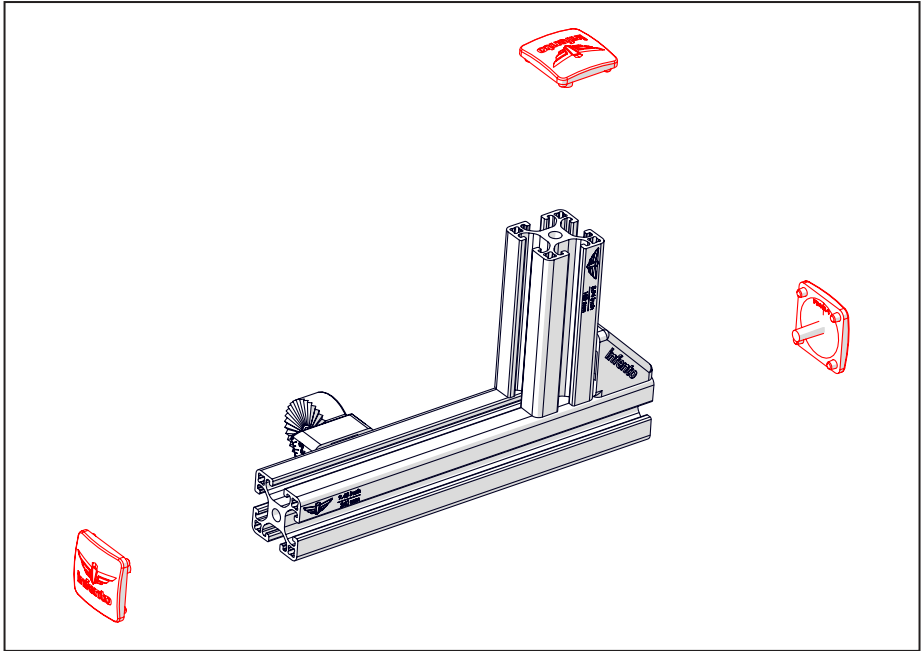

Protect cap



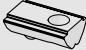

5

Phone mount

-  1x
-  1x
-  2x
-  1x

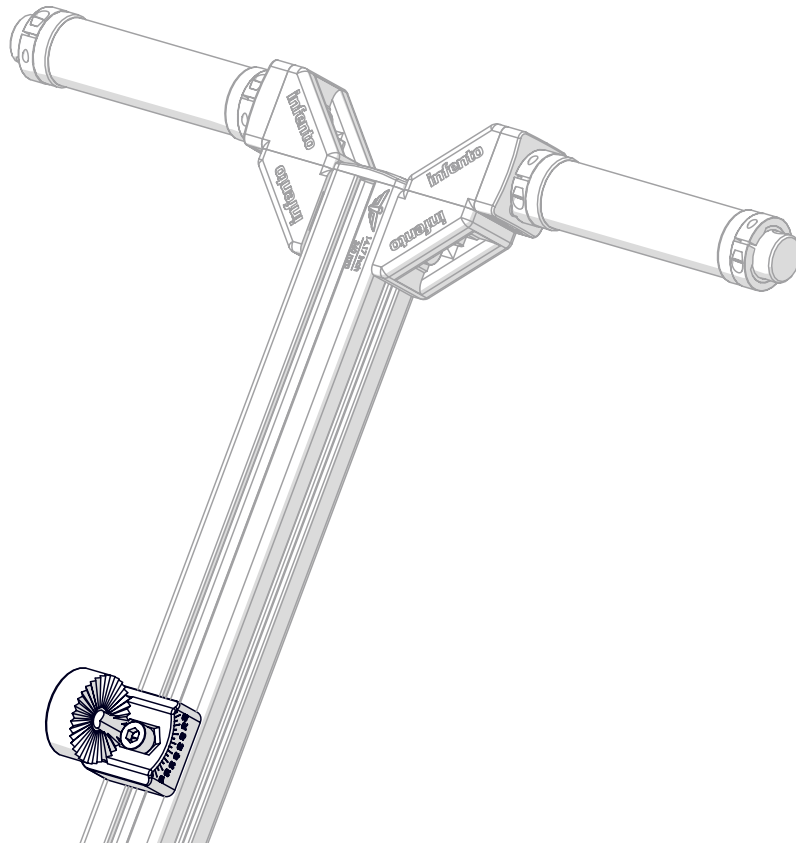
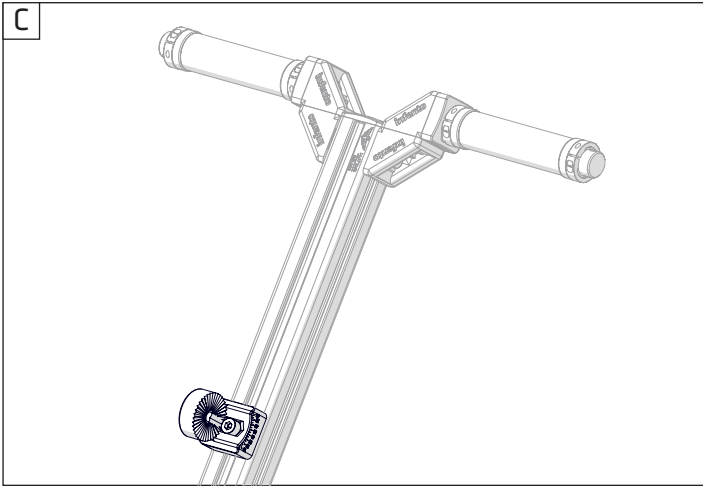
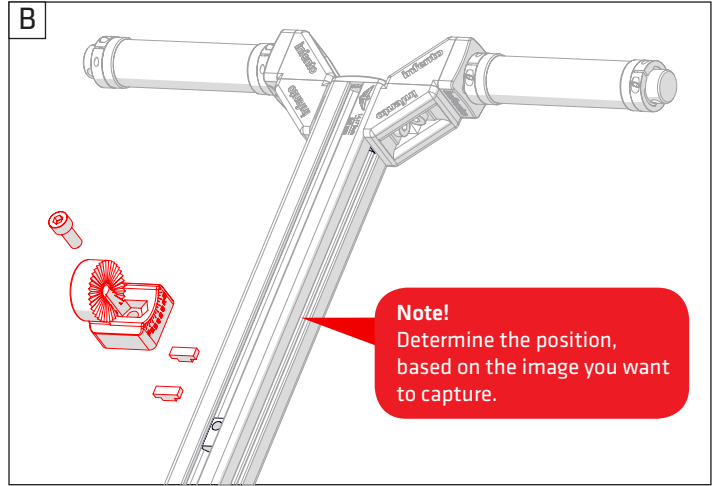
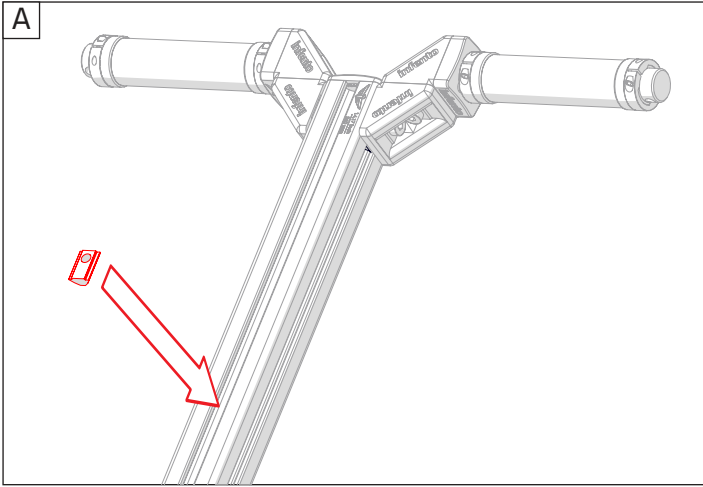



6

Phone mount

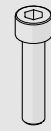

1x

Bolt M8x35



1x

Locknut M8

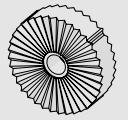

1x

Knurled disc 2 stripes

A

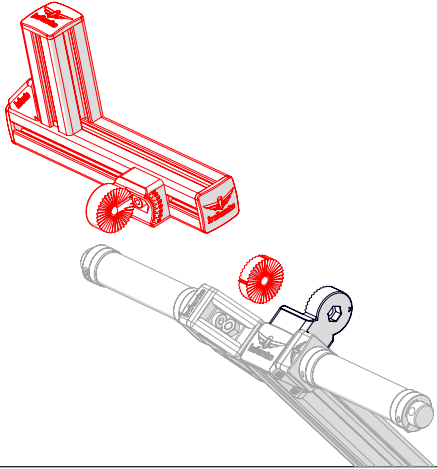

B

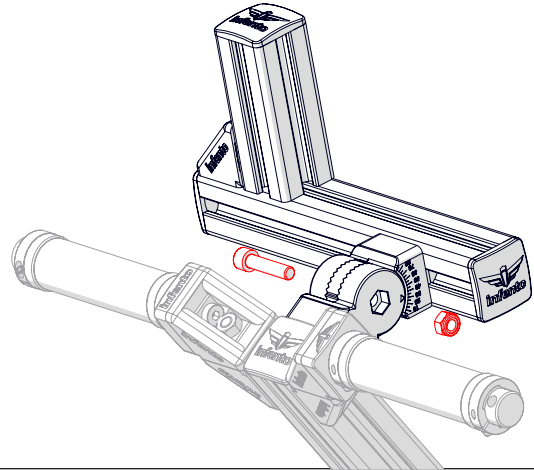

C

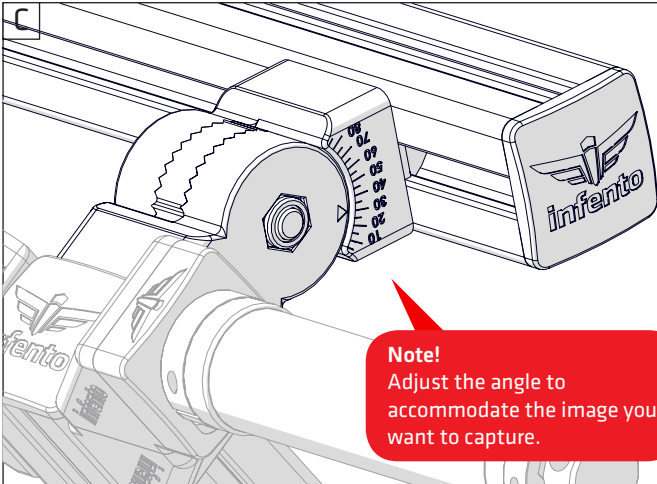

Note!
Adjust the angle to accommodate the image you want to capture.

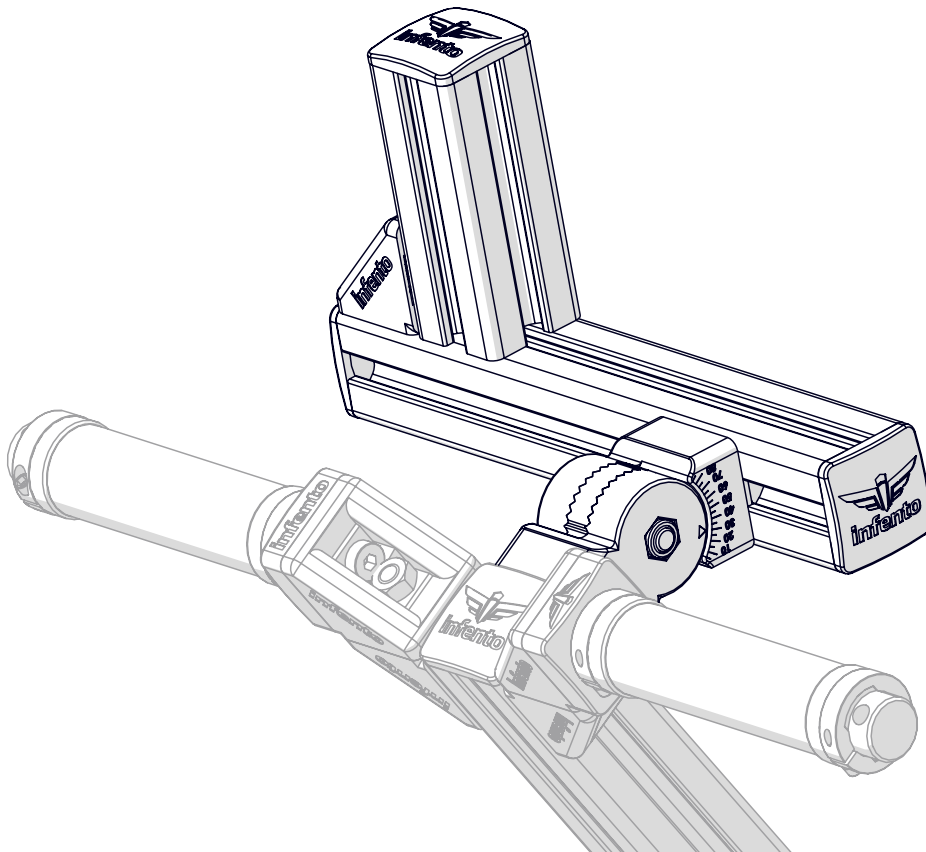



7

Phone mount



3x

Brake cable clip

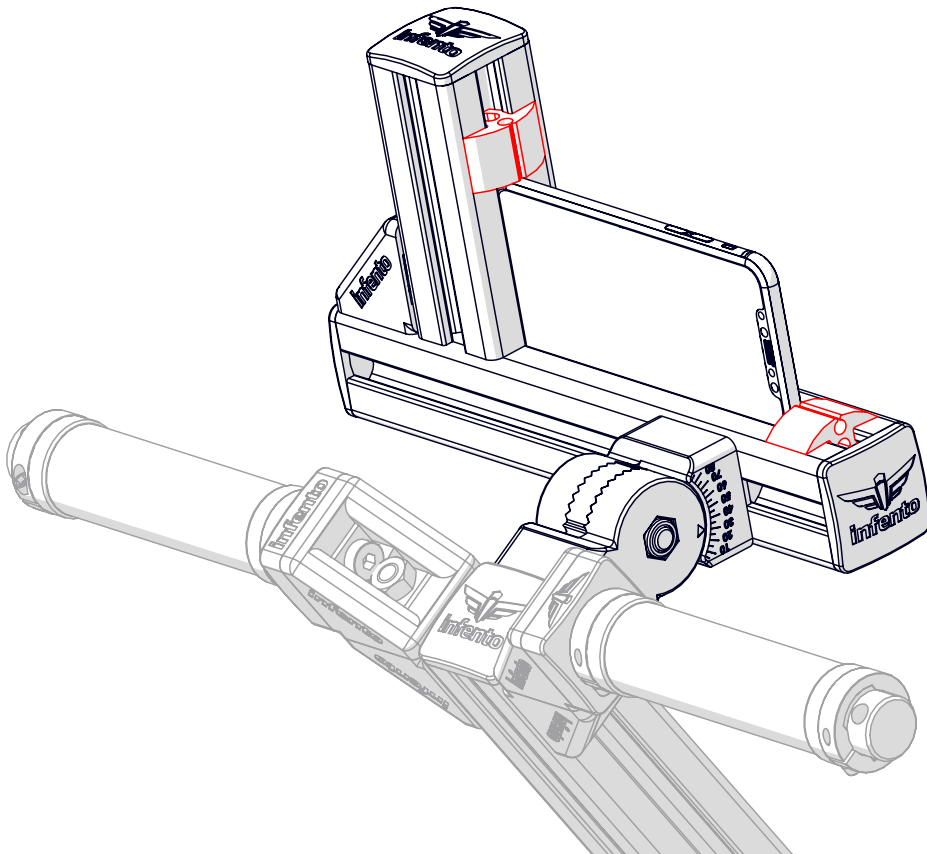
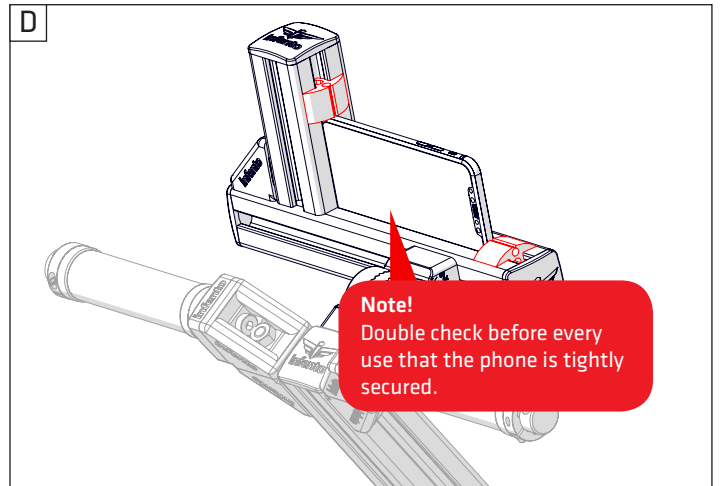
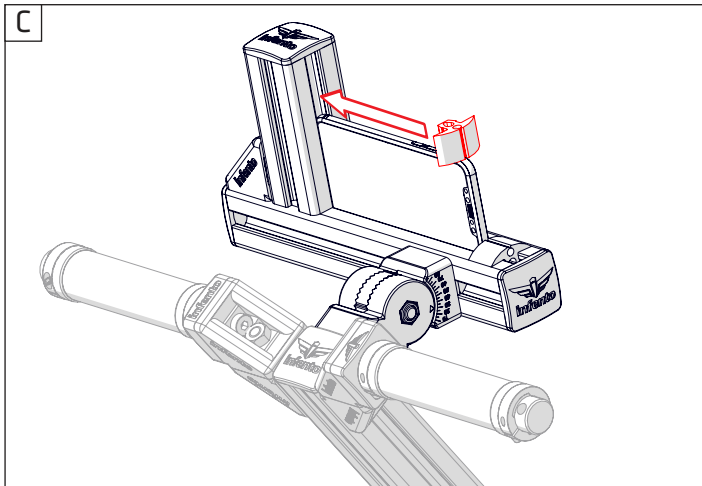
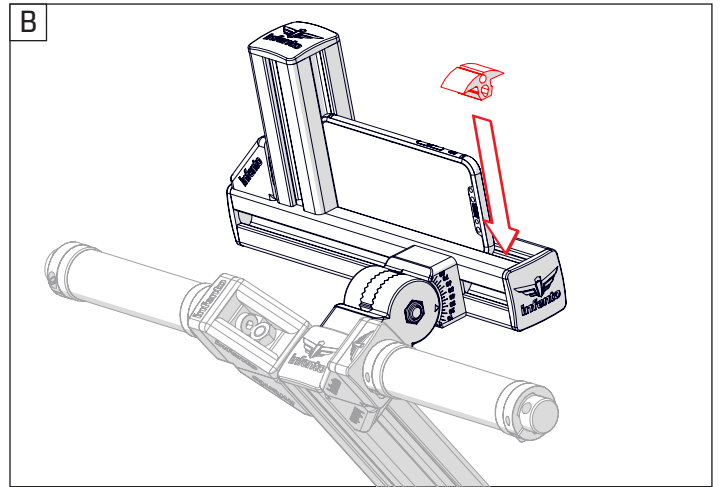
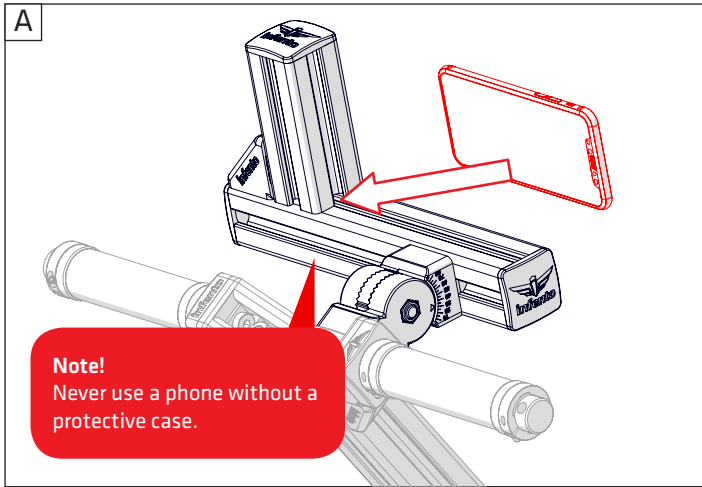

PHONE mount



THANK YOU FOR READING ME!